

# HYPER 7 PBS

## FRONT PARTS BLOWUP

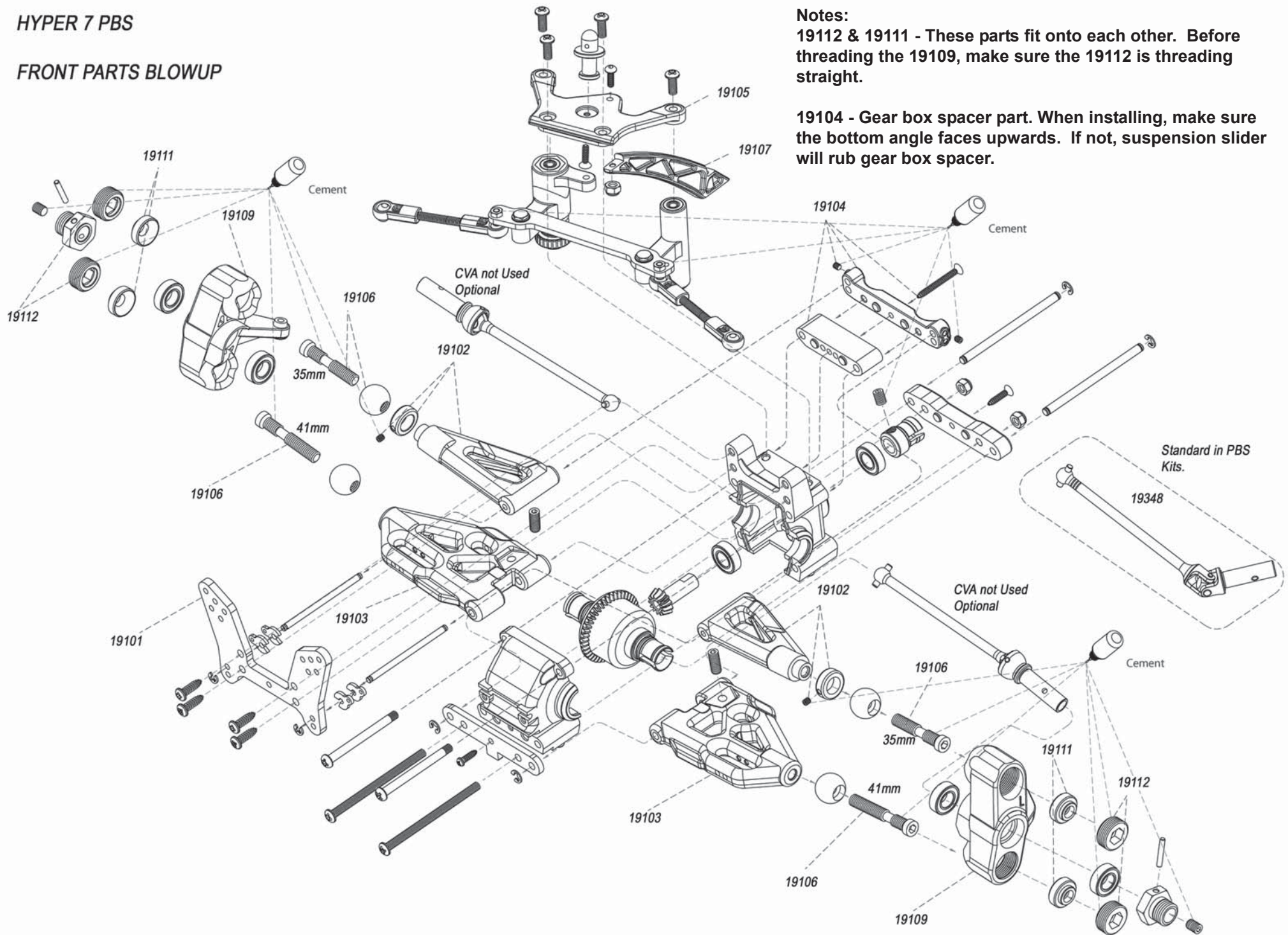

# HYPER 7 PBS

## REAR PARTS BLOWUP

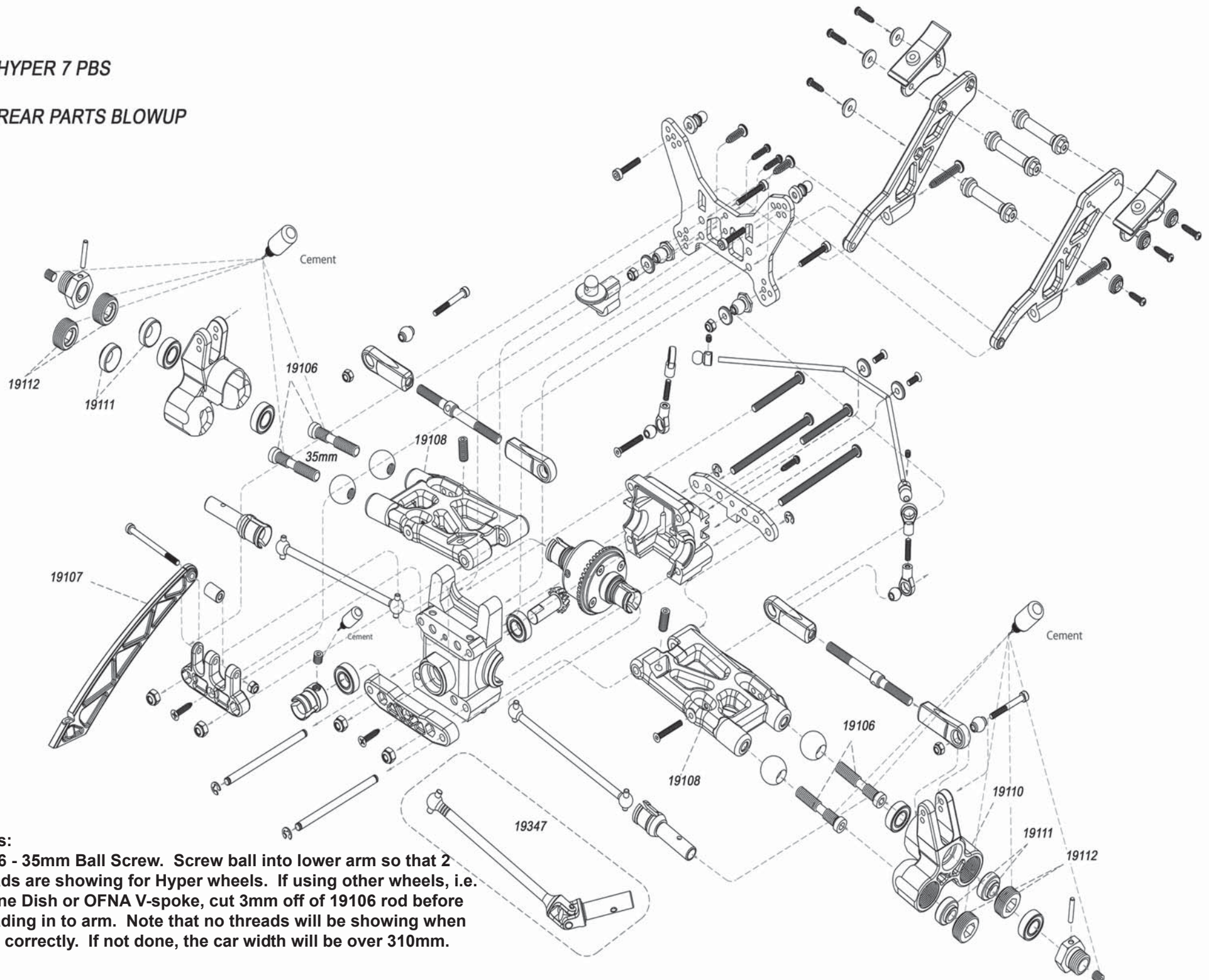

**Notes:**  
19106 - 35mm Ball Screw. Screw ball into lower arm so that 2 threads are showing for Hyper wheels. If using other wheels, i.e. Proline Dish or OFNA V-spoke, cut 3mm off of 19106 rod before threading in to arm. Note that no threads will be showing when done correctly. If not done, the car width will be over 310mm.